

### Application

Suitable for interior, top hung sliding panels.

Ideal for sliding panels and shutters in residential and commercial applications. Versatile design allows the opening to be covered by any number of panels.

The aluminium track may be fitted directly to the lintel, in single or multiple lines, or face fitted to the lintel using a single line of brackets or the specifically designed face fix track. Fascia accessory with end caps also available.

Hangers come standard with a steel bracket and four nylon tyred wheels with precision bearings. Clip stops provided but can be upgraded to a soft close device for improved operation.

### Panel Specification

|                        |                          |
|------------------------|--------------------------|
| <b>Track System:</b>   | <b>Zero Clearance 60</b> |
| For Individual Panels: |                          |
| Max Panel Weight       | 60kg                     |
| Max Panel Height       | 2400mm                   |
| Min Panel Thickness    | 28mm*                    |

\*(Applies to single panels, maximum panel thickness may vary for bi-passing panel applications)

### Standard Sets and Packs

Sets comprise of top track, brackets or face fix track, hangers, clip stops or soft closes, guide, spanner and timber screws.

| Set No.        | Panel width     | Track Length | Qty Brackets   |
|----------------|-----------------|--------------|----------------|
| ZC60-20/1      | 610mm to 915mm  | 2000mm       | 5              |
| ZC60-30/1      | 915mm to 1525mm | 3000mm       | 8              |
| ZC60-S20/1     | 610mm to 915mm  | 2000mm       | 5              |
| ZC60-S30/1     | 915mm to 1525mm | 3000mm       | 8              |
| ZC60F-S20/1CA  | 610mm to 915mm  | 2000mm       | Face Fix track |
| ZC60F-S20/1PWT | 610mm to 915mm  | 2000mm       | Face Fix track |

Kits with Face fix tracks available with clear anodised or powder coat white fascias. Other colours also available upon request.

|                 |  |
|-----------------|--|
| <b>Pack No.</b> |  |
| ZC60-1PK        | Fitting pack only, no track and brackets |

### Hardware Specification

|                  |                                   |
|------------------|-----------------------------------|
| <b>Track:</b>    | 60A                               |
| Standard lengths | 2000mm, 3000mm, 4000mm and 6000mm |
| Material         | Aluminium, Mill                   |

|                    |      |
|--------------------|------|
| <b>Brackets:</b>   |      |
| Single             | 91   |
| Pack of 5 brackets | 91/5 |

Bracket 91 made from stainless steel. Supplied with matching fasteners.

|                               |     |
|-------------------------------|-----|
| <b>Hangers (2 per panel):</b> |     |
| Hanger                        | 609 |

Hanger designed for 60CS for has a nylon body and comes with an extended, zinc plated steel bracket and four nylon tyred wheels with chrome precision bearings.

|        |     |
|--------|-----|
| Hanger | 610 |
|--------|-----|

Hanger designed for 60SCT has a nylon body and comes with a short, zinc plated steel bracket and four nylon tyred wheels with chrome precision bearings.

|                    |      |
|--------------------|------|
| <b>Clip Stops:</b> | 60CS |
|--------------------|------|

Adjustable clip stop made from POM, an engineered thermoplastic.

|               |     |
|---------------|-----|
| <b>Guide:</b> | 55G |
|---------------|-----|

Guide in white nylon, comes in two parts that fit on both sides of the panel. The guide is floor mounted.

|                                  |       |
|----------------------------------|-------|
| <b>Accessories:</b>              |       |
| Soft Close                       | 60SCT |
| Suitable for panels up to 60 kg. |       |

|                     |    |
|---------------------|----|
| Fascia and End Caps | 64 |
|---------------------|----|

Aluminium fascia available in 2000mm and 3000mm lengths in powder coat white or clear anodised.

|                   |     |
|-------------------|-----|
| Alternative Guide | 801 |
|-------------------|-----|

Spring loaded guide, nylon body and tip with zinc plated steel shaft. Designed to slide in the 92 and 130 thresholds.

|                   |      |
|-------------------|------|
| Alternative Guide | 101N |
|-------------------|------|

The nylon guide is designed to slide through a 20mm deep by 5mm wide sawcut in the bottom rail of the panel.

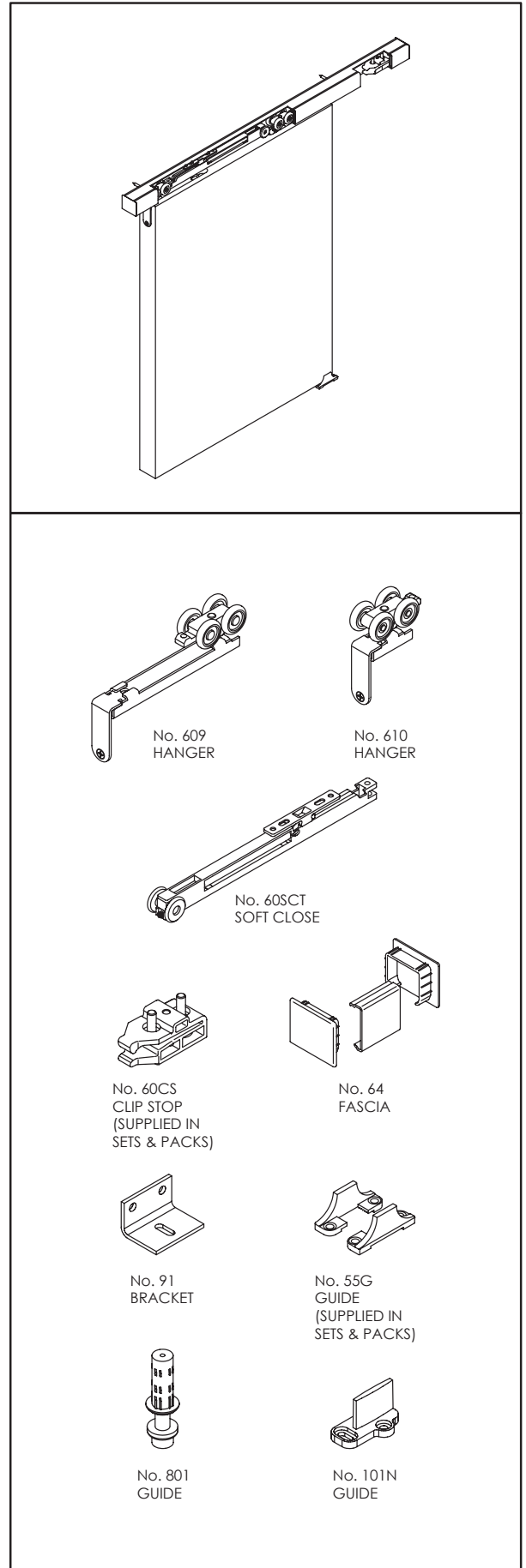

### 91LS BRACKETS

| Track Length | 2000 | 3000 | 4000 | 6000 |
|--------------|------|------|------|------|
| Bracket Qty. | 5    | 8    | 10   | 15   |

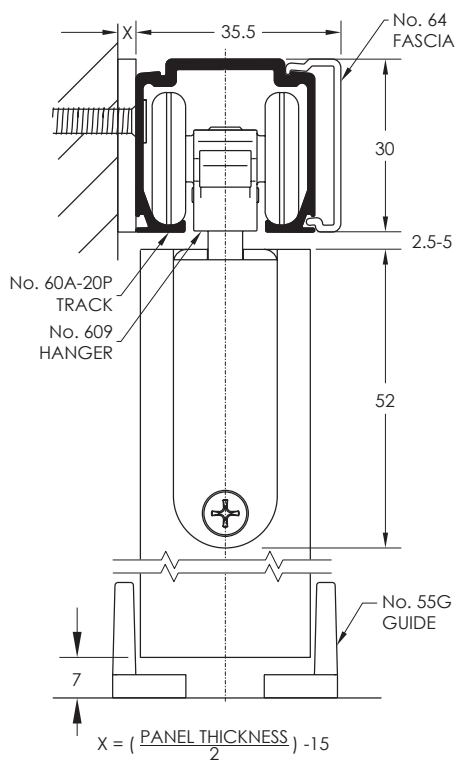
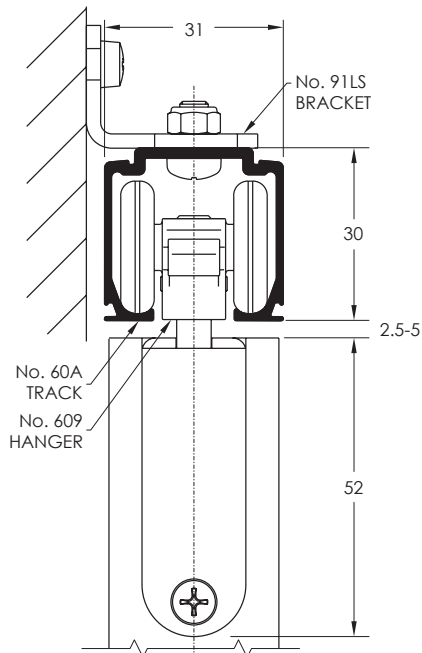

### TRACK & BRACKET FIXING CENTRES

USING 8G SCREWS, 50mm FROM EACH END, THEN SPACED AT APPROX 450mm INTERVALS

POSITION 1 (CLIP STOP)

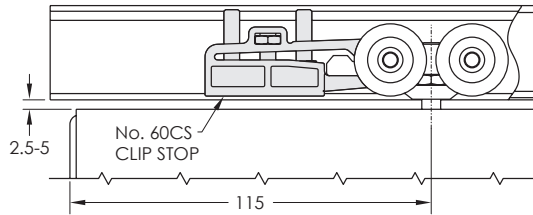

POSITION 2 (SOFT CLOSE)

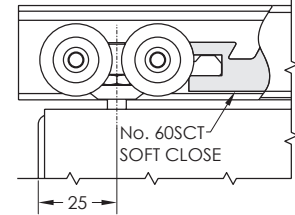

### PANEL PREPARATION AND INSTALLATION

1. PREPARE PANEL FOR MOUNTING PLATE. 2. FIT MOUNTING PLATE WITH SCREWS SUPPLIED

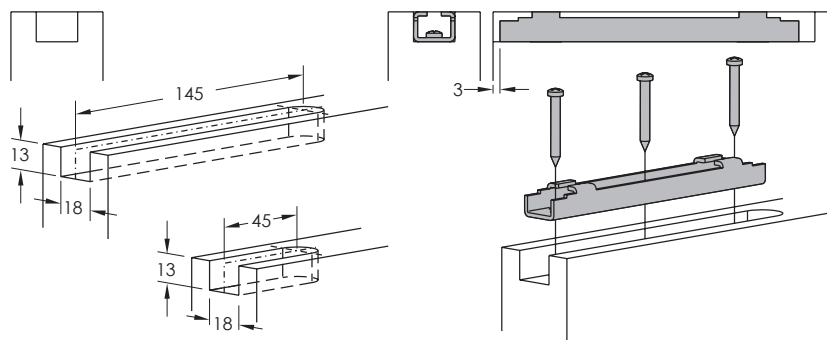

### ASSEMBLY

3. INSERT FIRST CLIP STOP & HANGERS INTO THE TRACK. THEN THE LAST CLIP STOP
4. ADJUST HANGER HEIGHT BY ROTATING THE BOLT WITH THE HANGER PLATE
5. SLIDE HANGER INTO THE MOUNTING BRACKET. DOUBLE CHECK CLEARANCE & ADJUST ACCORDINGLY
6. ONCE HEIGHT IS CORRECT & PANEL IS LEVEL, FIX PLATE TO THE PANEL

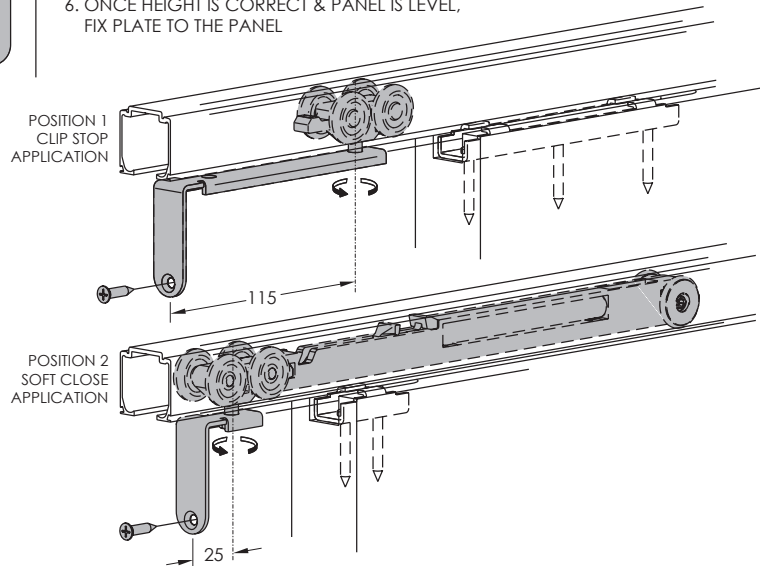

### ALTERNATIVE GUIDES

